

STAINLESS STEEL IS OUR **STRENGTH**



AUTODESK
AUTOCAD

Installing Stalatube profiles for Autodesk Autocad

Download 3D-library files from link below:

<https://www.stalatube.com/stainless-steel-design-tools/>



Extract file to desired
location

STALA
TUBE

STAINLESS STEEL IS OUR STRENGTH

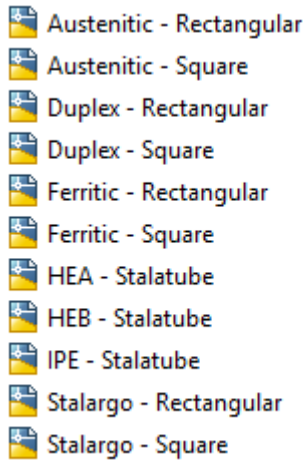

The folder containing the objects should look like the list on the left

Usage of Stalatube profiles

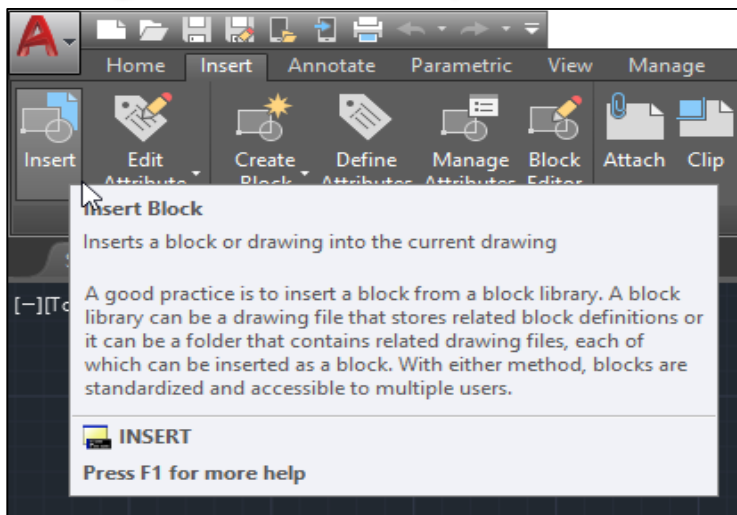

To add blocks to Autocad project select Insert Tab, and Insert command from the Ribbon

A new window opens

Browse to location you saved the files and pick one you need

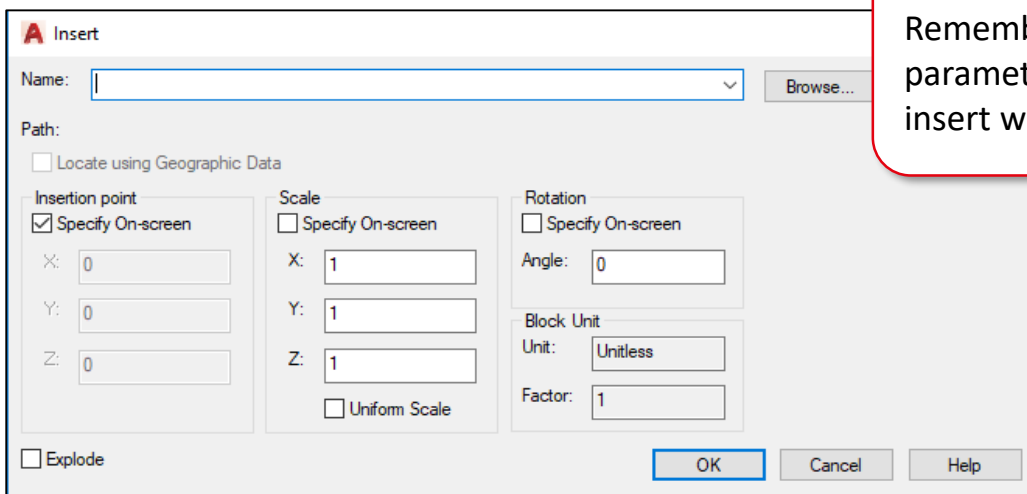

Remember to keep Scale parameters on 1 on insert window

STAINLESS STEEL IS OUR **STRENGTH**

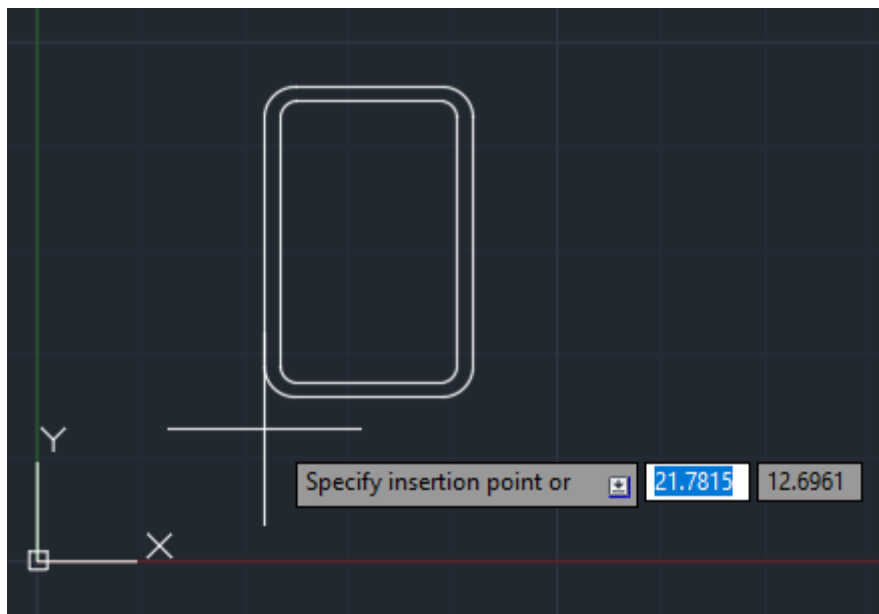

To insert the block to Autocad, press ok

You will get block added to your cursor like shown at the picture on left

To add it, press left mouse button

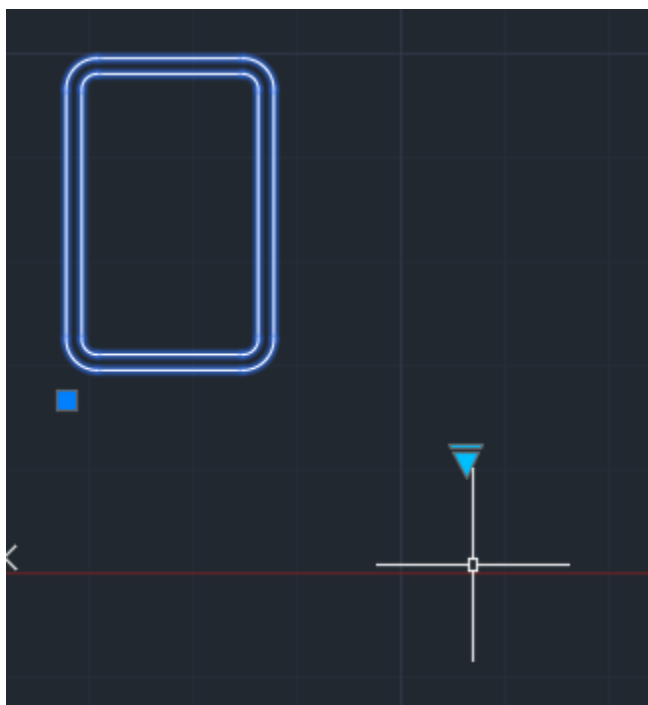

To change desired size pick the profile with left mouse button and a small arrow appears

By clicking the arrow, you can select the profile size you need